

SMV COMPUTER GROUPS, ASSOCIATING
 A FILE TYPE WITH A PROGRAM(2/24/04)
 windows 98(to be used with image page "FileTypes01.jpg")

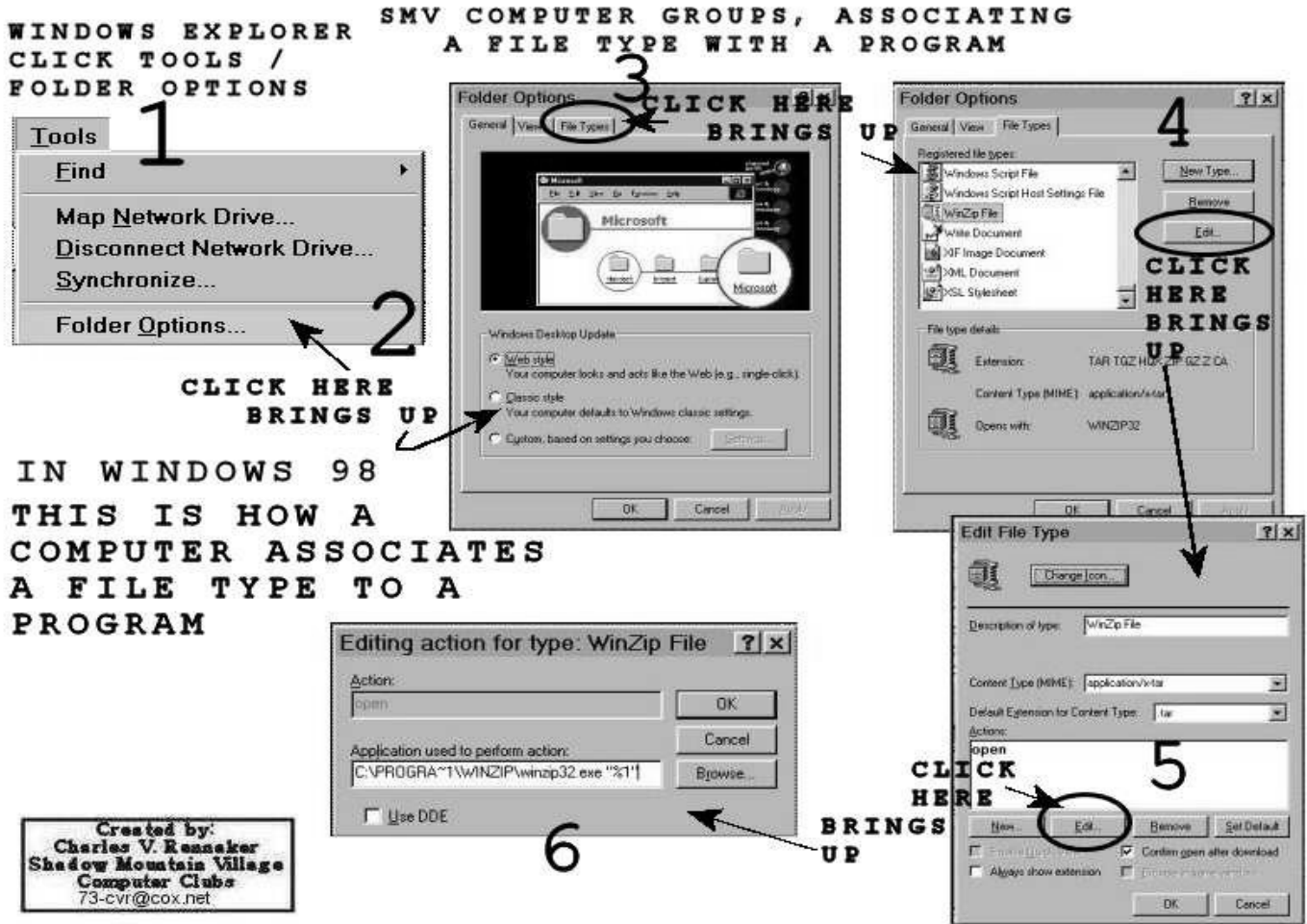

Open Windows Explorer, then click the TOOLS menu fig. 1, option list appears.

Click Folder Options from the list in fig. 1, fig. 3 comes up.

Click the File Types tab, fig. 3, fig. 4 comes up.

Windows 98 does not list file types by extension just by icon and name. For example: .doc file is shown as Microsoft Word Document. Scroll down till you see "Microsoft Word Document", left click it to select it. Click the EDIT button in fig. 4, fig. 5 comes up.

Note the information presented in fig. 5, in the content type(MIME) text box the file type .doc is shown, this is the file extension and reflects the type of file.

Click the EDIT button in fig. 5, fig. 6 comes up.

Fig. 6 now displays the program file and the path to the file that will open the program that will display the file with a .doc extension. This path should not have any ~ (**tilde**) figures in the path. Some entries in this window for file types will have the ~ symbol and still work, only because there are no other files with the same characters preceding the symbol.

In this example the file to open a .doc file is shown as "Winword.exe" which is the file that opens Microsoft Word. On a computer that does not have Microsoft Word installed this path would have led to the file "Wordpad.exe" which will also open a file with a .doc extension, however if the file were created in Microsoft Word (An OFFICE application) and was saved in the Microsoft Word default file type it could not be opened in Wordpad and be readable, it would have had to be saved in a .doc file type that could be read in Wordpad. Not many file types like .doc have different file types options for the same extensions.

For this information exercise, make a point to study file types by checking file names and extensions. In the case mentioned above with the files with the ~ symbol in the file name means that the name, at one time, had more than eight characters in it. Windows 95 was the one of the first operating systems to support long file names.(example, xxxxxxxxxxx.doc, instead of xxxxxxx.doc where there were eight X's and a three character extension) and was re-written as follows micros~1.doc where the file name had only 8 characters. If you find this window contains a ~ in the path, click BROWSE to locate the exe file shown then click OK you are safer.

Charles V. Rennaker,
77home9@smvcc.net